

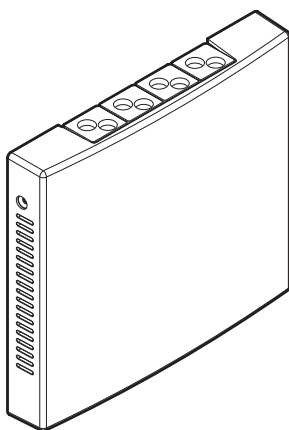

Installation manual

Daikin HomeHub



EKRHH ▲

▲ = , , A, B, C, ..., Z

Installation manual
Daikin HomeHub

English

Table of contents

1	About this document	2
2	Specific installer safety instructions	2
3	About the Daikin HomeHub	2
3.1	Components	3
3.2	Basic parameters	3
3.3	Compatibility	3
4	About the box	3
4.1	To unpack the Daikin HomeHub	3
5	Installation	3
5.1	Precautions when installing the Daikin HomeHub	3
5.2	Installation site requirements	3
5.3	Opening and closing the Daikin HomeHub	4
5.3.1	To open the Daikin HomeHub	4
5.3.2	To close the Daikin HomeHub	4
5.4	Connecting the electrical wiring	4
5.4.1	To connect the electrical wiring	4
5.4.2	Overview of electrical connections	5
5.5	Mounting the Daikin HomeHub	5
5.5.1	To mount the Daikin HomeHub	5
6	Starting up the system	6
7	Hand-over to the user	6

1 About this document

Target audience

Authorised installers

Documentation set

This document is part of a documentation set. The complete set consists of:

- **General safety precautions:**
 - Safety instructions that you must read before installing
 - Format: Paper (in the box of the indoor unit)
- **Installation manual:**
 - Installation instructions
 - Format: Paper (supplied in the kit)
- **Installer reference guide:**
 - Preparation of the installation, good practices, reference data, ...
 - Format: Digital files on <https://www.daikin.eu>. Use the search function 🔍 to find your model.

Scan the QR code below to find the full documentation set and more information about your product on the Daikin website.

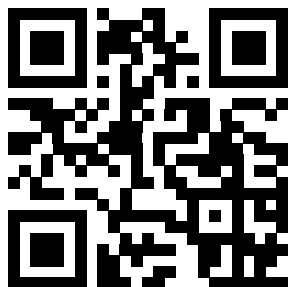

The latest revision of the supplied documentation is published on the regional Daikin website and is available via your dealer.

The original instructions are written in English. All other languages are translations of the original instructions.

2 Specific installer safety instructions

Always observe the following safety instructions and regulations.

General



DANGER

All wiring **MUST** be performed by an authorised electrician and **MUST** comply with the applicable national wiring regulation. **Possible consequence:** property damage and electrocution.



WARNING

Make sure installation, servicing, maintenance and repair comply with instructions from Daikin and with applicable legislation (for example national gas regulation) and are executed **ONLY** by authorised persons.

Installation (see "**5 Installation**" ▶ 3))



DANGER: RISK OF ELECTROCUTION

- Turn off the power supply before installing the Daikin HomeHub.
- Do NOT handle the Daikin HomeHub with wet hands.
- Do NOT let the Daikin HomeHub get wet.
- Do NOT disassemble, modify or repair the Daikin HomeHub.
- Turn OFF the power supply in case the Daikin HomeHub gets damaged.



DANGER: RISK OF ELECTROCUTION

Do NOT connect or turn on power supply before you have mounted the Daikin HomeHub, connected the electrical wiring and have closed the Daikin HomeHub.



NOTICE

The Daikin HomeHub use cases are compatible with Daikin Altherma and Multi+(DHW) units running the latest MMI version. Ensure to update the Hydro firmware to the latest version via the Updater Tool. See the installer reference guide of the Daikin HomeHub for more details on compatibility. You must connect the Daikin HomeHub with a LAN cable to the home Internet.

3 About the Daikin HomeHub

The Daikin HomeHub (EKRHH) is a versatile smart solution that serves as a central hub to connect and control Daikin equipment. In addition, the Daikin HomeHub also functions as an interface for smart energy management and home control. The Daikin HomeHub allows for app control of a heat pump system and, depending on the model, allows for the integration of a heat pump system in a Smart Grid application.

**NOTICE**

There can ONLY be 1 home energy management (HEM) system [Daikin HomeHub or third party] in a house. Using multiple HEM systems can result in the malfunctioning of one or more of them. In some special cases, an energy manager can be integrated in a home battery or an EV charging station. If there is already a HEM system installed in the house, it is better to use the Daikin HomeHub as an interface.

For more information about the possible use cases and their application, see the installer reference guide.

3.1 Components

Bottom

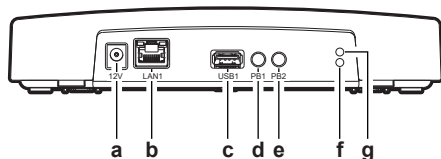

- a DC power jack input (12~24 V)
- b Ethernet port (LAN1)
- c USB Type A port (USB1)
- d Push button (PB1)
- e Push button (PB2)
- f LED (Blue)
- g LED (Green)

Top

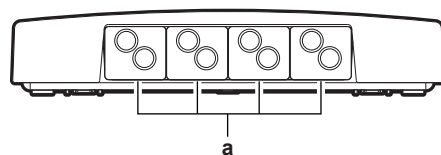

- a Rubber grommets

3.2 Basic parameters

Parameter	Value
Power supply	DC 12~24 V
IP class	IP20

3.3 Compatibility

Depending on the use case and unit configuration, compatibility of the Daikin HomeHub with specific units may differ. The Daikin HomeHub use cases are compatible with Daikin Altherma and Multi+ (DHW) units running the latest MMI version. Ensure to update the Hydro firmware to the latest version via the Updater Tool. For more information about the specific use cases of the Daikin HomeHub and general compatibility with units and other systems, see the installer reference guide.

4 About the box

Keep the following in mind:

- At delivery, the unit MUST be checked for damage and completeness. Any damage or missing parts MUST be reported immediately to the claims agent of the carrier.

4.1 To unpack the Daikin HomeHub

- 1 Open the box.
- 2 Take out the Daikin HomeHub.

3 Separate the accessories.

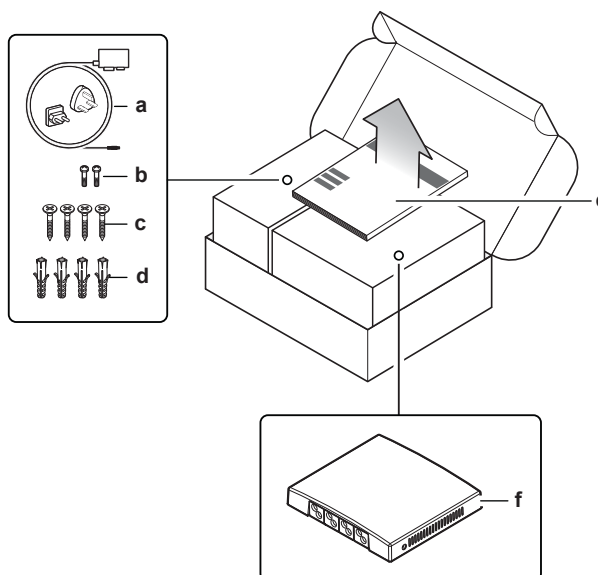

- a AC/DC power adapter with regional plug adapters (EU/UK)
- b Casing screws (x2)
- c Mounting screws (x4)
- d Wall plugs (x4)
- e Installation manual
- f Daikin HomeHub

5 Installation

5.1 Precautions when installing the Daikin HomeHub



DANGER: RISK OF ELECTROCUTION

- Turn off the power supply before installing the Daikin HomeHub.
- Do NOT handle the Daikin HomeHub with wet hands.
- Do NOT let the Daikin HomeHub get wet.
- Do NOT disassemble, modify or repair the Daikin HomeHub.
- Turn OFF the power supply in case the Daikin HomeHub gets damaged.

5.2 Installation site requirements

Do NOT install the Daikin HomeHub in the following places:

- In places where it is exposed to direct sunlight.
- In places where it is near a heat source.
- In places where it is exposed to a source of steam.
- In places where it is exposed to machine oil vapour.
- In places where it may be exposed to water, or in generally moist areas.

The Daikin HomeHub is designed:

- To be mounted in dry, indoor locations only.
- To be installed in a vertical orientation only.
- To operate in ambient temperatures ranging from -10~50°C.

Make sure a clean installation of the wired P1/P2 connections is possible.

Mind the following spacing installation guidelines:

5 Installation

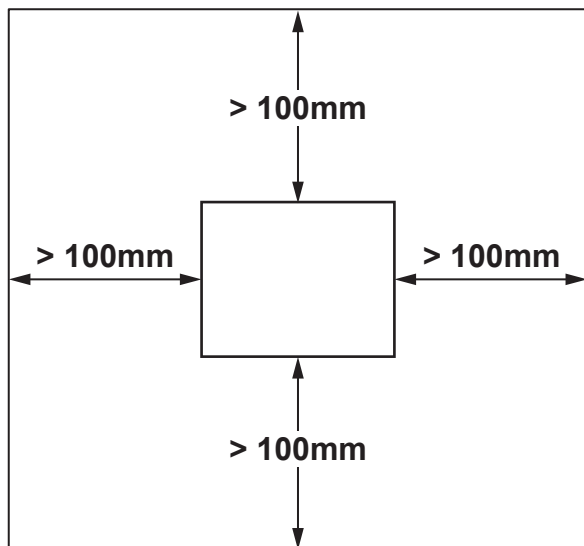

- Provide enough space (>100 mm) on the top side of the Daikin HomeHub to allow field wiring to enter through the rubber grommets.
- Provide enough space (>100 mm) on the left and right side of the Daikin HomeHub, so that a screwdriver can fit in order to remove or tighten the casing screws, and in order to not block any ventilation holes.
- Provide enough space (>100 mm) on the bottom side of the Daikin HomeHub to connect the Ethernet cable on the bottom side without exceeding its minimum bend radius (typically 90 mm).
- When installing the Daikin HomeHub in a control cabinet or enclosure, make sure there is sufficient clearance in front of the Daikin HomeHub to be able to close the cabinet or enclosure.
- Place the Daikin HomeHub within 2.5 m of a fuse box.



INFORMATION

Also read the maximum cable length requirements set out in "[5.4.2 Overview of electrical connections](#)" [▶ 5].

5.3 Opening and closing the Daikin HomeHub

5.3.1 To open the Daikin HomeHub

- 1 Remove the 2 casing screws on the sides of the Daikin HomeHub with a screwdriver.
- 2 Detach the front casing from the rear casing.

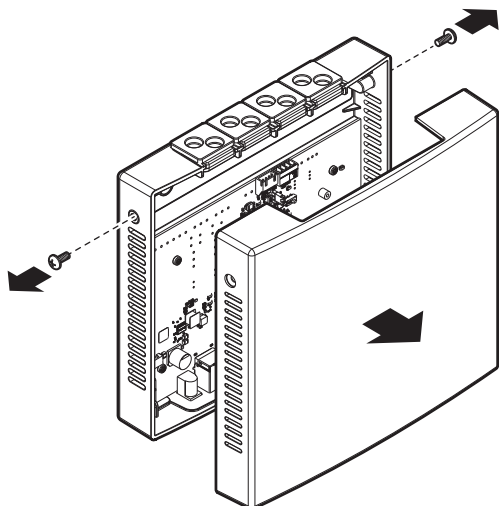

5.3.2 To close the Daikin HomeHub

- 1 Attach the front casing to the rear casing.

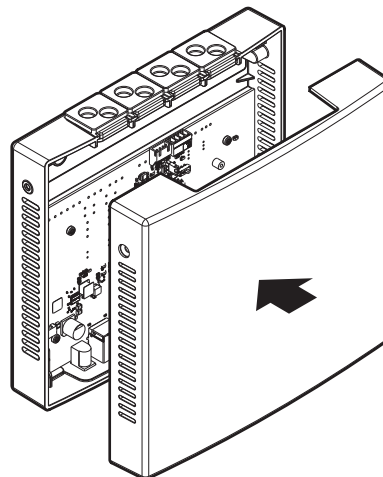

- 2 Gently push or adjust the front casing until it clicks into the rear casing.
- 3 Insert the 2 casing screws in the holes.
- 4 Tighten the screws.

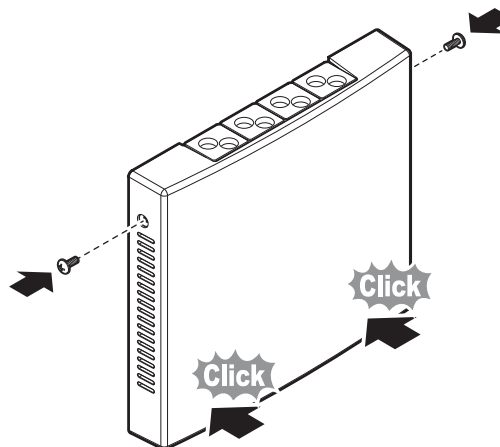

5.4 Connecting the electrical wiring



DANGER: RISK OF ELECTROCUTION

Do NOT connect or turn on power supply before you have mounted the Daikin HomeHub, connected the electrical wiring and have closed the Daikin HomeHub.



NOTICE

The wiring for connection is NOT included.

5.4.1 To connect the electrical wiring

- 1 Connect the power supply and communication cable(s) to the appropriate terminals. (See following figures per use case.)
- 2 Ensure strain relief by fixing the cables with cable ties (field supply) to the cable tie mountings in the Daikin HomeHub.

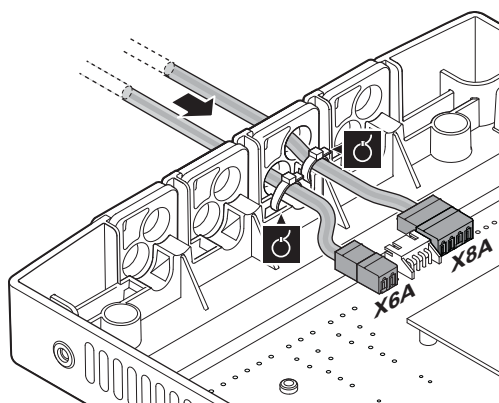

5.4.2 Overview of electrical connections

Connectors

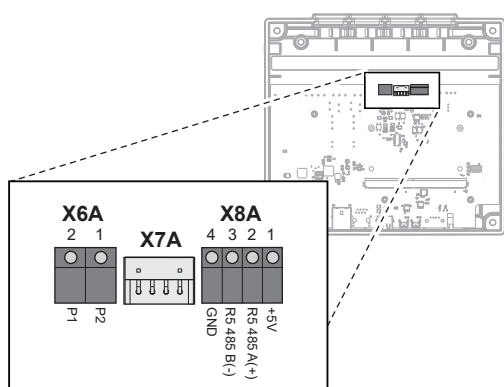

- X6A** To indoor unit (P1/P2 connector)
X7A To indoor unit (S21 connector) – NOT supported
X8A To Modbus interface (RS-485 connector)

Connections



INFORMATION

Wiring from the top. Remove the grommets from the rear casing when connecting the electrical wiring. Before sliding the grommets back into the holes, cut them open with a utility knife, so that you can let the wiring enter the Daikin HomeHub through the grommets. The grommets **MUST** be inserted into the holes before you insert the wiring into the Daikin HomeHub.

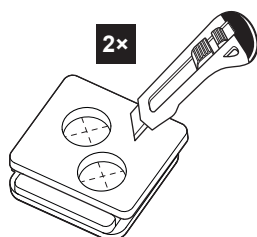

Indoor unit (P1/P2)

	Connector X6A (screw terminal)
	See the manual or other available documentation of the indoor unit
	Only use harmonised wire providing double insulation suitable for the applicable voltage. Wire size: 0.75–1.25 mm ² Maximum length: 500 m



Voltage: 16 V DC — 120 mA

Modbus Interface (RS-485)

	Connector X8A (screw terminal)
	See the installation manual of the Home Energy Manager (HEM) or Energy Utility Controller
	Only use harmonised wire providing double insulation suitable for the applicable voltage. Wire size: 0.75–1.25 mm ² Maximum length: 500 m

5.5 Mounting the Daikin HomeHub

The Daikin HomeHub is mounted to a wall or other flat surface by way of mounting holes in the rear casing. Mounting the Daikin HomeHub to a DIN rail (field supply) is also a possibility.

5.5.1 To mount the Daikin HomeHub

Mounting to a wall

Prerequisite: The front casing of the Daikin HomeHub is removed.

- 1 Determine the mounting location for the Daikin HomeHub. See ["5.2 Installation site requirements"](#) [p. 3] for more information.
- 2 Drill holes for the plugs and insert the plugs.
- 3 Mount the rear casing to the wall by inserting and tightening the 4 included mounting screws.

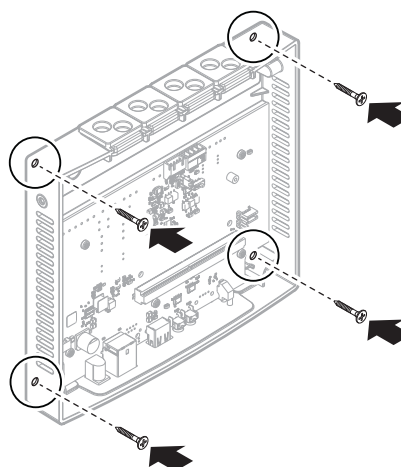

Mounting to a DIN rail

Prerequisite: The front casing of the Daikin HomeHub is removed.

- 1 Determine the mounting location for the Daikin HomeHub. See ["5.2 Installation site requirements"](#) [p. 3] for more information.
- 2 Connect the DIN rail clips to the back of the Daikin HomeHub and secure with screws.
- 3 Mount the Daikin HomeHub onto the DIN rail (field supply), using the clips on the back of the Daikin HomeHub to seat it onto the rail and click it into place.

6 Starting up the system

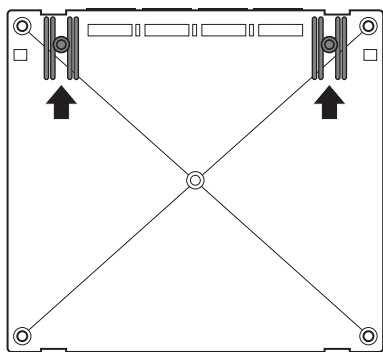

6 Starting up the system

The Daikin HomeHub is powered by the included power supply. For instructions on how to configure the Daikin HomeHub for a specific use case, see the installer reference guide.



NOTICE

The Daikin HomeHub use cases are compatible with Daikin Altherma and Multi+(DHW) units running the latest MMI version. Ensure to update the Hydro firmware to the latest version via the Updater Tool. See the installer reference guide of the Daikin HomeHub for more details on compatibility. You must connect the Daikin HomeHub with a LAN cable to the home Internet.

7 Hand-over to the user

After having installed and configured the Daikin HomeHub, hand over this installation manual to the user and make him/her aware of the safety precautions.

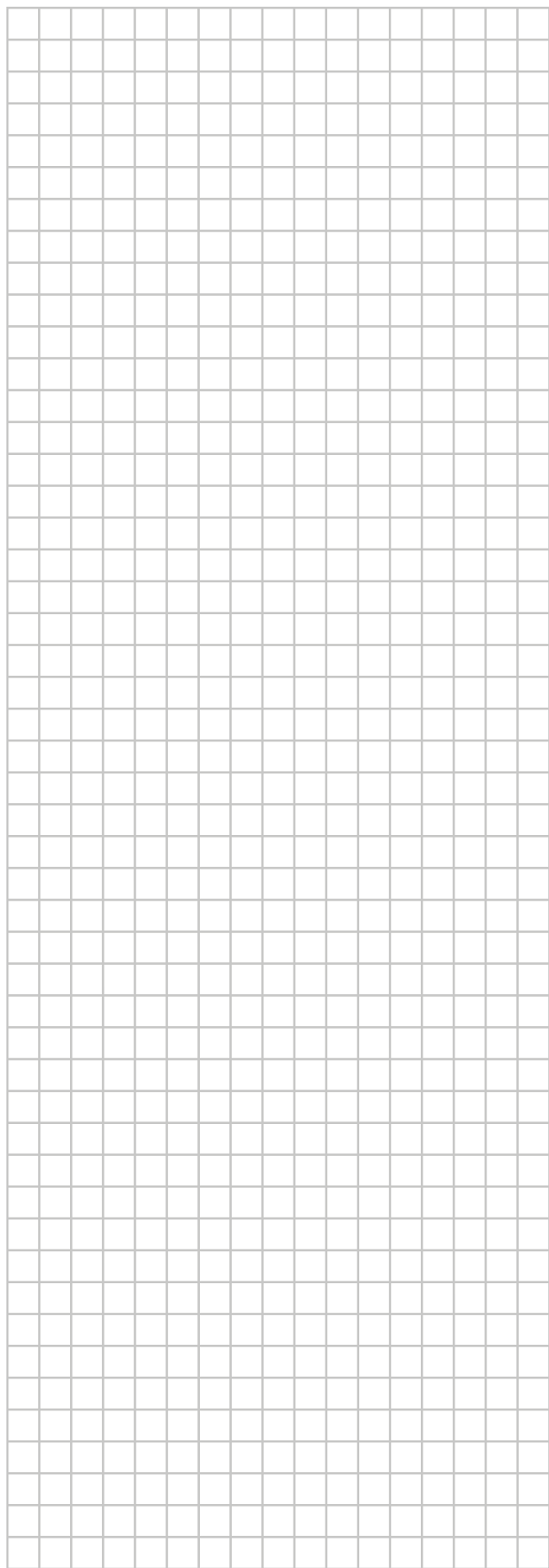



4P702816-1 C 0000000\$

Copyright 2022 Daikin

DAIKIN EUROPE N.V.

Zandvoordestraat 300, B-8400 Oostende, Belgium

4P702816-1C 2024.05